



ITALIANO

**“Set messa in fase motori
PSA 1.9D, 2.0D HDi, 2.2D HDi”**

Rev.1 012016

FG 192/PS15



FASATURA MOTORE

AVVERTENZE



FARE SEMPRE RIFERIMENTO ALLE ISTRUZIONI DEL COSTRUTTORE DEL VEICOLO E AL MANUALE DEL VEICOLO PER CONOSCERE I DATI E LE PROCEDURE DA UTILIZZARE.
IL PRESENTE DOCUMENTO E' DA CONSIDERARSI A PURO TITOLO INDICATIVO.



UTILIZZARE SEMPRE ADEGUATI GUANTI PROTETTIVI.



UTILIZZARE SEMPRE ADEGUATI OCCHIALI DI PROTEZIONI



ATTENZIONE

La sincronizzazione sbagliata o fuori fase del motore può danneggiare le valvole. L'uso di questi utensili di messa in fase è esclusivamente a discrezione dell'utilizzatore e, la Fasangas S.r.l. non può essere considerata responsabile di eventuali danni al motore causati dall'utilizzo di questi utensili.

IMPORTANTI PRECAUZIONI DI SICUREZZA:

- Staccare sempre il cavo a massa della batteria (verificare se è disponibile il codice radio).
- NON girare l'albero motore o l'albero a camme con la cinghia / catena di distribuzione smontata.
- Togliere le candele di accensione per far girare più facilmente il motore.
- Girare sempre il motore nel senso normale di rotazione (salvo indicazione contraria).
- NON girare il motore agendo sull'albero a camme o su altri pignoni.
- Rispettare tutte le coppie di serraggio.
- NON utilizzare mai liquidi detergenti su cinghie, rulli o ruote dentate.

DESCRIZIONE DEL CONTENUTO: ATTREZZI SPECIALI

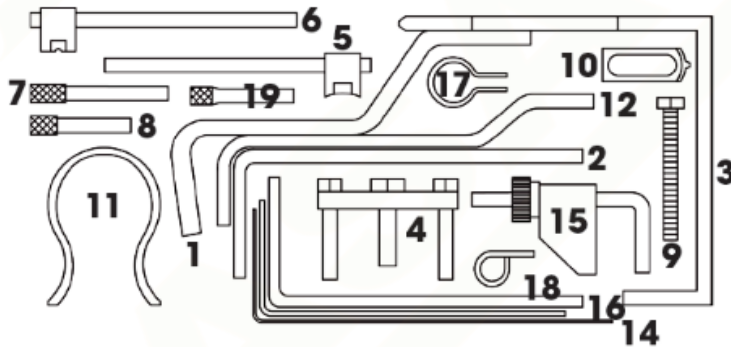

| # | Cod. FASANO TOOLS | OEM | Descrizione | # | Cod. FASANO TOOLS | OEM | Descrizione |
|----|-------------------|--|---|----|-------------------|-------------------------------------|---|
| 1 | FG 192/PS15-1 | 0188-D 0153-N | Perno di fasatura del volano | 11 | FG 192/PS15-11 | 0188-K | Fermaglio cinghia di distribuzione |
| 2 | FG 192/PS15-2 | 0188-X | Perno bloccaggio volano | 12 | FG 192/PS15-12 | 0153-N 0188-D 0188-Y 0288D | Perno di fasatura del volano - 8 mm |
| 3 | FG 192/PS15-3 | 0188-Y 0288D | Perno di fasatura del volano - 8 mm | 13 | FG 192/PS15-13 | 0153-AL 0153-T.H. | Attrezzo di centraggio del pignone albero motore |
| 4 | FG 192/PS15-4 | 0188.P | Estrattore della puleggia albero motore | 14 | FG 192/PS15-14 | 0188-Q2 0188.Q2 | PERNO DI BLOCCAGGIO DEL TENDICINGHIA |
| 5 | FG 192/PS15-5 | 0188-J2 | Attrezzo di tensionamento | 15 | FG 192/PS15-15 | 0188-AD 0188.AD | Morsetto cinghia di distribuzione |
| 6 | FG 192/PS15-6 | 0178-E 0188-J/J1 | Attrezzo di tensionamento | 16 | FG 192/PS15-16 | 0188-Q1 0188.Q1 | Attrezzo di bloccaggio della puleggia del tendicinghia cinghia organi ausiliari |
| 7 | FG 192/PS15-7 | 0188-M | Perno di fasatura 8mm | 17 | FG 192/PS15-17 | 0188-AH 0188.AH | Attrezzo di centraggio del pignone albero motore |
| 8 | FG 192/PS15-8 | 0188-H | Perno di fasatura 6mm | 18 | FG 192/PS15-18 | 0188.X | Perno di fasatura volano |
| 9 | FG 192/PS15-9 | | Bullone M8x80mm | 19 | FG 192/PS15-19 | 0132-AJ1 | Perno bloccaggio albero a camme (scarico / motori 16V) – diam. 8mm |
| 10 | FG 192/PS15-10 | 0188.F 0134Q 1.870.765.001 1.870.827.000 0134-AF 9044-T 1871000400 | Attrezzo di bloccaggio del volano | | | | |

APPLICAZIONI

CITROËN

| ATTREZZI | MODELLO | kW (hp) | CODICE MOTORE | MOTORE | |
|--------------------------------------|--|-----------|-----------------|--------------------|---|
| 2, 3/12, 4, 5, 7, 10, 11 | Berlingo/Berlingo First I/II (1999-2007) - con pignone albero a camme regolabile | 66 (90) | RHY (DW10TD) | 2.0 HDi | D |
| 3/12, 4, 5, 7, 10, 14, 15 | Berlingo/Berlingo First I/II (1999-2007) – con pignone albero motore regolabile) | 66 (90) | RHY (DW10TD) | 2.0 HDi | D |
| 3/12, 4, 5, 7, 10, 14, 15 | Berlingo/Berlingo First I/II (2001-2007) | 66 (90) | RHY (DW10TD) | 2.0 HDi | D |
| 2/18, 4, 7, 10, 14, 15, 17 | C4 (2008-2011) | 103 (140) | RHF (DW10BTED4) | 2.0 HDi | D |
| 2/18, 4, 7, 10, 14, 15, 17 | C4 (2004-2011) | 100 (136) | RHR (DW10BTED4) | 2.0 HDi | D |
| 2/18, 4, 7, 10, 14, 15 | C4 Picasso/Grand Picasso (2006-2011) | 100 (136) | RHJ (DW10BTED4) | 2.0 HDi | D |
| 2/18, 7, 10, 14 | C4 Picasso/Grand Picasso (2007-2012) | 100 (136) | RHR (DW10BTED4) | 2.0 HDi | D |
| 2/18, 4, 7, 10, 15, 17 | C5 II (2007-2008) | 93 (126) | RHL (DW10BTED4) | 2,0 HDi | D |
| 2/18, 4, 7, 10, 15, 14, 17 | C5 II (2004-2008) | 100 (136) | RHR (DW10BTED4) | 2,0 HDi | D |
| 2/18, 3/12, 4, 7, 10, 14, 15, 17, 19 | C5 III (2008-2011) | 103 (140) | RHF (DW10BTED4) | 2,0 HDi | D |
| 2/18, 3/12, 4, 7, 10, 15, 14, 19 | C5 III (2007-2010) | 100 (136) | RHR (DW10BTED4) | 2,0 HDi | D |
| 2/18, 4, 7, 10, 15, 17 | C8 (2006-2010) | 100 (136) | RHR (DW10BTED4) | 2,0 HDi | D |
| 2/18, 3/12, 4, 7, 10, 15, 17, 19 | Dispatch/Jumpy III (2007-2012) | 100 (136) | RHR (DW10BTED4) | 2,0 HDi | D |
| 3/12, 7, 10, 14 | C4 II (2011-2015) | 100 (136) | RHD (DW10C) | 2,0 HDi | D |
| 3/12, 4, 7, 10, 14, 15, 17 | C4 II (2011-2013) | 110 (150) | RHE (DW10CTED4) | 2,0 HDi | D |
| 3/12, 7, 10, 14 | C4 II (2010-2015) | 120 (163) | RHH (DW10C) | 2,0 HDi | D |
| 3/12, 4, 7, 10, 14, 15, 17 | C4 Picasso/Grand Picasso (2010-2013) | 110 (150) | RHB (DW10DTE4) | 2,0 HDi | D |
| 3/12, 4, 7, 10, 14, 15, 17 | C4 Picasso/Grand Picasso (2013-2015) | 110 (150) | RHB (DW10CTED4) | 2,0 HDi | D |
| 4, 7, 10, 14, 15, 17, 18 | C4 Picasso/Grand Picasso (2006-2011) | 100 (136) | RHJ (DW10BTED4) | 2,0 HDi | D |
| 4, 7, 10, 14, 15, 17, 18 | C4 Picasso/Grand Picasso (2006-2011) | 100 (136) | RHR (DW10BTED4) | 2,0 HDi | D |
| 3/12, 4, 7, 10, 14, 15, 17 | C4 Picasso/Grand Picasso (2008-2013) | 110 (150) | RHE (DW10CTED4) | 2,0 HDi | D |
| 3/12, 4, 7, 10, 14, 15, 17 | C4 Picasso/Grand Picasso (2013-2015) | 110 (150) | RHE (DW10CTED4) | 2,0 HDi | D |
| 3/12, 4, 7, 10, 14, 15, 17 | C4 Picasso/Grand Picasso (2009-2013) | 120 (163) | RHH (DW10CTED4) | 2,0 HDi | D |
| 3/12, 4, 7, 10, 15, 16 | C4 Picasso/Grand Picasso II (2013-2015) | 100 (136) | AHV (DW10FD) | 2,0 BlueHDi | D |
| 3/12, 4, 7, 10, 15, 16, 17 | C4 Picasso/Grand Picasso II (2013-2015) | 110 (150) | AHX (DW10FD) | 2,0 BlueHDi | D |
| 3/12, 4, 7, 10, 15, 16, 17 | C4 Picasso/Grand Picasso II (2014-2015) | 110 (150) | AHX (DW10FD) | 2,0 BlueHDi | D |
| 3/12, 4, 7, 10, 15, 16, 17 | C4 Picasso/Grand Picasso II (2013-2015) | 110 (150) | AHX (DW10FD) | 2,0 e-HDi Airdream | D |
| 3/12, 4, 5, 7, 10, 14, 15, 18 | C4 Sedan (2007-2011) | 80 (109) | RHZ (DW10ATED4) | 2,0 HDi | D |

CITROËN

| ATTREZZI | MODELLO | kW (hp) | CODICE MOTORE | MOTORE | |
|--------------------------------------|---------------------------------|-----------|--------------------|-------------|---|
| 2, 3/12, 4, 5, 7, 10, 11, 14, 15 | C5 (2000-2004) | 79 (107) | RHS (DW10ATED) | 2,0 HDi | D |
| 2, 3/12, 4, 5, 7, 10, 11, 14, 15 | C5 (2000-2004) | 66 (90) | RHY (DW10TD) | 2,0 HDi | D |
| 2, 3/12, 4, 5, 7, 10, 11, 14, 15 | C5 (2000-2004) | 80 (109) | RHZ (DW10ATED) | 2,0 HDi | D |
| 3/12, 4, 7, 10, 14, 15, 17 | C5 III (2010-2013) | 100 (136) | RHD (DW10CTED4) | 2,0 HDi | D |
| 3/12, 4, 7, 10, 14, 15, 17 | C5 III (2010-2013) | 110 (150) | RHE (DW10CTED4) | 2,0 HDi | D |
| 3/12, 4, 7, 10, 15, 17 | C5 III (2009-2013) | 120 (163) | RHH (DW10CTED4) | 2,0 HDi | D |
| 3/12, 4, 7, 10, 14, 15, 17 | C8 (2007-2013) | 100 (136) | RHD (DW10CTED4) | 2,0 HDi | D |
| 3/12, 4, 7, 10, 14, 15, 17 | C8 (2007-2013) | 120 (163) | RHH (DW10CTED4) | 2,0 HDi | D |
| 2/18, 4, 5, 7, 10, 11, 16 | C8 (2002-2007) | 79 (109) | RHM (DW10ATED4) | 2,0 HDi | D |
| 2/18, 4, 5, 7, 10, 11, 16 | C8 (2002-2007) | 79 (109) | RHT (DW10ATED4/L4) | 2,0 HDi | D |
| 2/18, 4, 5, 7, 10, 11, 16 | C8 (2002-2007) | 79 (109) | RHW (DW10ATED4) | 2,0 HDi | D |
| 2, 3/12, 4, 5, 7, 10, 11, 14, 15 | Dispatch/Jumpy I/II (1999-2007) | 80 (109) | RHZ (DW10ATED/L3) | 2,0 HDi | D |
| 2, 7, 10 | Dispatch/Jumpy I/II (2004-2007) | 81 (110) | RHM (DW10ATED4) | 2,0 HDi 16V | D |
| 2, 3/12, 4, 5, 7, 10, 11, 12, 14, 15 | Dispatch/Jumpy I/II (2000-2007) | 80 (109) | RHW (DW10JATED4) | 2,0 HDi 16V | D |
| 3/12, 4, 7, 10, 14, 15, 17 | Dispatch/Jumpy III (2011-2013) | 72 (98) | AHY (DW10CE) | 2,0 HDi | D |
| 3/12, 4, 7, 10, 14, 15, 17 | Dispatch/Jumpy III (2010-2013) | 94 (128) | AHZ (DW10CTED4) | 2,0 HDi | D |
| 2/18, 3/12, 4, 7, 10, 15, 17, 19 | Dispatch/Jumpy III (2008-2012) | 88 (120) | RHG (DW10UTED4) | 2,0 HDi | D |
| 3/12, 4, 7, 10, 14, 15, 17 | Dispatch/Jumpy III (2010-2013) | 120 (163) | RHH (DW10CTED4) | 2,0 HDi | D |
| 3/12, 4, 7, 10, 15, 17, 18, 19 | Dispatch/Jumpy III (2007-2012) | 88 (120) | RHK (DW10UTED4) | 2,0 HDi | D |
| 3/12, 4, 7, 10, 14, 15, 17 | DS4 (2011-2013) | 100 (136) | RHD (DW10C) | 2,0 HDi | D |
| 3/12, 4, 7, 10, 14, 15, 17 | DS4 (2011-2013) | 120 (163) | RHH (DW10C) | 2,0 HDi | D |
| 3/12, 4, 7, 10, 15, 17 | DS5 (2012-2013) | 100 (136) | RHD (DW10CTED4) | 2,0 HDi | D |
| 3/12, 4, 7, 10, 14, 15, 17 | DS5 (2012-2013) | 120 (163) | RHH (DW10CTED4) | 2,0 HDi | D |
| 3/12, 4, 7, 10, 14, 15, 17 | DS5 (2012-2013) | 120 (163) | RHC (DW10CTED4) | 2,0 HYbrid4 | D |
| 2, 3/12, 4, 5, 7, 10, 11 | Relay/Jumper II (2002-2006) | 62 (85) | RHV (DW10UTD) | 2,0 HDi | D |
| 2, 3/12, 4, 5, 7, 10, 11 | Synergie/Evasion (1999-2002) | 80 (110) | RHZ (DW10ATED) | 2,0 HDi | D |
| 2, 3/12, 4, 5, 7, 10, 11 | Synergie/Evasion (2000-2002) | 80 (110) | RHW (DW10ATED4) | 2,0 HDi 16V | D |
| 2, 3/12, 4, 5, 7, 10, 11 | Xantia (1998-2000) | 66 (90) | RHY (DW10ATD) | 2,0 HDi | D |
| 2, 3/12, 4, 5, 7, 10, 11 | Xantia (1998-2001) | 80 (110) | RHZ (DW10ATED) | 2,0 HDi | D |
| 2, 3/12, 4, 5, 7, 10, 11 | Xsara (1999-2000) | 66 (90) | DW10TD (RHY) | 2,0 HDi | D |
| 2, 3/12, 4, 5, 7, 10, 11 | Xsara II (2000-2001) | 66 (90) | RHY (DW10TD) | 2,0 HDi | D |
| 2, 3/12, 4, 5, 7, 10, 11, 14, 15 | Xsara II (2000-2006) | 80 (110) | RHZ (DW10ATED) | 2,0 HDi | D |
| 2, 3/12, 4, 5, 7, 10, 11, 14, 15 | Xsara Picasso (1999-2006) | 66 (90) | RHY (DW10TD) | 2,0 HDi | D |
| 2, 3/12, 4, 5, 7, 10, 11, 14, 15 | Xsara Picasso (2001-2006) | 66 (90) | RHY (DW10TD) | 2,0 HDi | D |
| 2, 3/12, 4, 5, 7, 10, 11 | Xsara Picasso (2001-2006) | 80 (109) | RHZ (DW10ATED) | 2,0 HDi | D |

CITROËN

| ATTREZZI | MODELLO | kW (hp) | CODICE MOTORE | MOTORE | |
|-------------------------------------|--|-----------|-----------------|---------|---|
| 3/12, 4, 5, 7, 10, 14, 15 | Xsara II (2001-2006) | 66 (90) | RHY (DW10TD) | 2,0 HDi | D |
| 5, 7, 10, 11, 18 | C5 (2000-2004) | 98 (133) | 4HX (DW12TED4) | 2,2 HDi | D |
| 2/18, 7, 10, 15, 17 | C-Crosser (2010-2012) | 115 (156) | 4HK (DW12MTED4) | 2,2 HDi | D |
| 3/12, 4, 5, 6, 7, 10, 11, 14, 15 | Relay/Jumper II (2002-2006) | 77 (104) | 4HY (DW12UTED) | 2,2 HDi | D |
| 3/12, 4, 5, 6, 8, 9, 10, 11, 14, 15 | Berlingo/Berlingo First I/II (2000-2007) | 51 (69) | WJY (DW8B/L4) | 1,9 | D |
| 3/12, 6, 8, 9, 11 | Berlingo/Berlingo First I/II (1998-2002) | 51 (70) | WJZ (DW8/LW3) | 1,9 | D |
| 3/12, 6, 8, 9, 11 | Berlingo/Berlingo First I/II (1998-2002) | 51 (70) | WJZ (DW8/LW3) | 1,9 | D |
| 3/12, 6, 8, 9, 11 | C15 (2001-2006) | 43 (58) | WJZ (DW8B) | 1,9 | D |
| 3/12, 6, 8, 9, 11 | Dispatch/Jumpy I/II (1999-2007) | 51 (70) | WJY (DW8B) | 1,9 | D |
| 3/12, 6, 8, 9, 11 | Dispatch/Jumpy I/II (1999-2007) | 51 (70) | WJZ (DW8/L/W3) | 1,9 | D |
| 3/12, 6, 8, 9, 11 | Xsara (1998-2000) | 51 (70) | DW8/L3 (WJZ) | 1,9 | D |
| 3/12, 6, 8, 9, 11 | Xsara (1998-2000) | 51 (70) | DW8/L3 (WJZ) | 1,9 | D |
| 3/12, 6, 8, 9, 11 | Xsara II (2000-2004) | 51 (72) | WJY (DW8B) | 1,9 | D |
| 3/12, 6, 8, 9, 11 | Xsara II (2000-2004) | 51 (71) | WYZ (DW8B/L4) | 1,9 | D |

FIAT

| ATTREZZI | MODELLO | kW (hp) | CODICE MOTORE | MOTORE | |
|--------------|-------------------|-----------|------------------|------------------|---|
| 3/12, 10, 17 | Scudo (2007-2012) | | RHR (DW10BTED4) | 2,0 MultiJet 140 | D |
| 3/12, 10, 17 | Scudo (2008-2012) | 88 (120) | RHG (DW10UTED4) | 2,0 MultiJet 120 | D |
| 3/12, 10, 17 | Scudo (2007-2012) | 88 (120) | RHK (DW10UTED4) | 2,0 MultiJet 120 | D |
| 3/12, 10, 17 | Scudo (2011-2013) | 94 (128) | RH02 (DW10CTED4) | 2,0 MultiJet 130 | D |
| 3/12, 10, 17 | Scudo (2010-2013) | 120 (163) | RHH (DW10CTED4) | 2,0 MultiJet 165 | D |

PEUGEOT

| ATTREZZI | MODELLO | kW (hp) | CODICE MOTORE | MOTORE | |
|-----------------------------------|------------------------|-----------|-----------------|---------|---|
| 2/18, 4, 7, 10, 13, 14, 17 | 307 (2003-2008) | 100 (136) | DW10BTED4 (RHR) | 2,0 HDi | D |
| 2/18, 4, 7, 10, 13, 14, 17 | 307 CC (2005-2009) | 100 (136) | DW10BTED4 (RHR) | 2,0 HDi | D |
| 2/18, 3/12, 7, 10, 14, 15, 17 | 308 (2009-2012) | 103 (140) | DW10BTED4 (RHF) | 2,0 HDi | D |
| 2/18, 3/12, 7, 10, 14, 15, 17 | 308 (2007-2011) | 100 (136) | DW10BTED4 (RHR) | 2,0 HDi | D |
| 2/18, 3/12, 7, 10, 14, 15, 17 | 308 CC (2009-2012) | 103 (140) | DW10BTED4 (RHF) | 2,0 HDi | D |
| 2/18, 3/12, 7, 10, 14, 15, 17 | 308 CC (2009-2011) | 100 (136) | DW10BTED4 (RHR) | 2,0 HDi | D |
| 2/18, 3/12, 7, 10, 14, 15, 17 | 308 CC (2009-2011) | 103 (140) | DW10BTED4 (RHR) | 2,0 HDi | D |
| 2/18, 4, 7, 10, 13, 14, 17 | 407 (2004-2010) | 100 (136) | DW10BTED4 (RHR) | 2,0 HDi | D |
| 2/18, 4, 7, 10, 13, 14, 17 | 407 Coupe (2007-2009) | 100 (136) | DW10BTED4 (RHR) | 2,0 HDi | D |
| 2/18, 3/12, 7, 10, 14, 15, 16, 17 | 508 (2011-2013) | 103 (140) | DW10BTED4 (RHF) | 2,0 HDi | D |
| 2/18, 3/12, 7, 10, 14, 15, 16, 17 | 508 (2011-2013) | 100 (136) | DW10BTED4 (RHR) | 2,0 HDi | D |
| 2/18, 4, 7, 10, 13, 14, 17 | 607 (2006-2011) | 93 (126) | DW10BTED4 (RHL) | 2,0 HDi | D |
| 2/18, 4, 7, 10, 15, 17 | 807 (2005-2010) | 100 (136) | DW10BTED4 (RHR) | 2,0 HDi | D |
| 2/18, 3/12, 4, 7, 10, 11, 16, 17 | Expert III (2007-2012) | 100 (136) | DW10BTED4 (RHR) | 2,0 HDi | D |

PEUGEOT

| ATTREZZI | MODELLO | kW (hp) | CODICE MOTORE | MOTORE | |
|-------------------------------|------------------------|-----------|--------------------|-------------------|---|
| 3/12, 4, 7, 10, 14, 15, 17 | Expert III (2007-2012) | 88 (120) | DW10BTED4 (RHR) | 2,0 HDi | D |
| 3/12, 4, 5, 7, 10, 11, 14, 15 | 206 (1999 -2006) | 66 (90) | DW10TD (RHY) | 2,0 HDi | D |
| 3/12, 7, 10, 15, 16, 17 | 3008 (2011-2013) | 100 (136) | DW10CB (RHD) | 2,0 HDi | D |
| 3/12, 7, 10, 14, 15, 16, 17 | 3008 (2009-2013) | 110 (150) | DW10CTED4 (RHE) | 2,0 HDi | D |
| 3/12, 7, 10, 14, 16, 17 | 3008 (2009-2013) | 120 (163) | DW10CTED4 (RHH) | 2,0 HDi | D |
| 7, 10, 14, 15, 16, 17, 18 | 3008 (2011-2013) | 120 (163) | DW10CTED4 (RHC) | 2,0 HYbrid4 | D |
| 3/12, 5, 7, 10, 14, 15 | 306 (1999-2002) | 66 (90) | DW10TD (RHY) | 2,0 HDi | D |
| 3/12, 4, 5, 7, 10, 11, 14, 15 | 307 (2001-2006) | 79 (110) | DW10ATED (RHS) | 2,0 HDi | D |
| 3/12, 4, 5, 7, 10, 11, 14, 15 | 307 (2001-2006) | 66 (90) | DW10TD (RHY) | 2,0 HDi | D |
| 3/12, 4, 5, 7, 10, 11, 14, 15 | 307 (2001-2006) | 66 (90) | DW10TD (RHY) | 2,0 HDi | D |
| 3/12, 7, 10, 14, 15, 16, 17 | 308 (2010-2013) | 100 (136) | DW10CTED4 (RHD) | 2,0 HDi | D |
| 3/12, 7, 10, 14, 15, 16, 17 | 308 (2010-2013) | 110 (150) | DW10CTED4 (RHE) | 2,0 HDi | D |
| 3/12, 7, 10, 14, 15, 16, 17 | 308 (2010-2013) | 120 (163) | DW10CTED4 (RHH) | 2,0 HDi | D |
| 3/12, 7, 10, 14, 15, 16, 17 | 308 CC (2009-2011) | 120 (163) | DW10CTED4 (RHH) | 2,0 HDi | D |
| 3/12, 4, 5, 7, 10, 11, 14, 15 | 406 (2001-2004) | 79 (110) | DW10ATED (RHS) | 2,0 HDi | D |
| 3/12, 5, 7, 10, 11, 14, 15 | 406 (1998-2004) | 80 (110) | DW10ATED (RHZ) | 2,0 HDi | D |
| 3/12, 5, 7, 10, 11, 14, 15 | 406 (1999-2004) | 66 (90) | DW10TD (RHY) | 2,0 HDi | D |
| 3/12, 4, 5, 7, 10, 14, 15 | 406 (2002-2004) | 66 (90) | DW10TD (RHY) | 2,0 HDi | D |
| 3/12, 7, 10, 14, 15, 16, 17 | 407 (2010-2011) | 100 (136) | DW10CTED4 (RHD) | 2,0 HDi | D |
| 3/12, 7, 10, 14, 15, 16, 17 | 407 (2010-2011) | 110 (150) | DW10CTED4 (RHE) | 2,0 HDi | D |
| 3/12, 7, 10, 14, 15, 16, 17 | 407 Coupe (2009-2012) | 120 (163) | DW10CTED4 (RHH) | 2,0 HDi | D |
| 3/12, 7, 10, 15, 16, 17 | 5008 (2011-2013) | 100 (136) | DW10CB (RHD) | 2,0 HDi | D |
| 3/12, 7,10, 14, 15, 16, 17 | 5008 (2009-2013) | 120 (163) | DW10CTED4 (RHH) | 2,0 HDi | D |
| 3/12, 7,10, 14, 15, 16, 17 | 508 (2012-2013) | 120 (163) | DW10CTED4 (RHC) | 2,0 e-HDi HYbrid4 | D |
| 3/12, 7,10, 14, 15, 16, 17 | 508 (2011-2013) | 100 (136) | DW10CTED4 (RHD) | 2,0 HDi | D |
| 3/12, 7,10, 14, 15, 16, 17 | 508 (2011-2013) | 120 (163) | DW10CTED4 (RHH) | 2,0 HDi | D |
| 3/12, 4, 5, 7, 10, 14, 15 | 607 (2001-2006) | 79 (110) | DW10ATED (RHS) | 2,0 HDi | D |
| 3/12, 4, 5, 7, 10, 14, 15 | 607 (2000-2006) | 80 (109) | DW10ATED (RHZ) | 2,0 HDi | D |
| 3/12, 4, 5, 7, 10, 14, 15 | 806 (1999-2002) | 80 (110) | DW10ATED (RHZ) | 2,0 HDi | D |
| 3/12, 4, 5, 7, 10, 14, 15 | 806 (1999-2002) | 80 (110) | DW10JATED4 (RHW) | 2,0 HDi 16V | D |
| 3/12, 4, 5, 7, 10, 14, 15 | 807 (2002-2007) | 79 (109) | DW10ATED4/L4 (RHT) | 2,0 HDi | D |
| 3/12, 4, 5, 7, 10, 14, 15 | 807 (2010-2013) | 100 (136) | DW10CTED4 (RHD) | 2,0 HDi | D |
| 3/12, 7, 10, 14, 15, 16, 17 | 807 (2010-2013) | 120 (163) | DW10CTED4 (RHH) | 2,0 HDi | D |
| 2/18, 3/12, 4, 5, 7, 10, 11 | 807 (2003-2007) | 79 (109) | DW10JATED4 (RHM) | 2,0 HDi | D |

PEUGEOT

| ATTREZZI | MODELLO | kW (hp) | CODICE MOTORE | MOTORE | |
|------------------------------------|---|-----------|--------------------|-------------|---|
| 3/12, 4, 5, 7, 10, 14, 15 | Expert I/II (2004-2007) | 81 (110) | DW10ATED4 (RHM) | 2,0 HDi 16V | D |
| 3/12, 4, 5, 7, 10, 11 | Boxer II (2002-2006) | 63 (85) | DW10UTD (RHV) | 2,0 HDi | D |
| 2/18, 3/12, 4, 5, 7, 10, 11 | Expert I/II (1999-2007) | 80 (109) | DW10JATED4 (RHW) | 2,0 HDi 16V | D |
| 3/12, 7, 10, 14, 15, 16, 17 | Expert III (2010-2013) | 94 (128) | DW10CD (AHZ) | 2,0 HDi | D |
| 3/12, 7, 10, 14, 15, 16, 17 | Expert III (2011-2013) | 72 (98) | DW10CE (AHY) | 2,0 HDi | D |
| 3/12, 7, 10, 14, 15, 16, 17 | Expert III (2010-2013) | 120 (163) | DW10CTED4 (RHH) | 2,0 HDi | D |
| 3/12, 4, 7, 10, 11, 14, 16, 17, 18 | Expert III (2007-2012) | 88 (120) | DW10UTED4 (RHG) | 2,0 HDi | D |
| 3/12, 4, 7, 10, 11, 14, 16, 17, 18 | Expert III (2007-2012) | 88 (120) | DW10UTED4 (RHK) | 2,0 HDi | D |
| 4, 5, 7, 10, 14, 15, 18 | Partner/Partner Origin/Ranch I/II (1999-2007) | 66 (90) | DW10TD (RHY) | 2,0 HDi | D |
| 4, 5, 7, 10, 14, 15, 18 | Partner/Partner Origin/Ranch I/II (2002-2007) | 66 (90) | DW10TD (RHY) | 2,0 HDi | D |
| 3/12, 7, 10, 14, 15, 16, 17, 18 | RCZ (2010-2013) | 120 (163) | DW10CTED4 (RHH) | 2,0 HDi | D |
| 2/18, 7, 10, 15, 17 | 4007 (2010-2012) | 115 (156) | DW12MTED4 (4HK) | 2,2 HDi | D |
| 2/18, 5, 7, 10, 11 | 406 (2001-2004) | 98 (133) | DW12ATED (4HX) | 2,2 HDi | D |
| 2/18, 5, 7, 10, 11 | 406 Coupe (2001-2006) | 98 (133) | DW12ATED (4HX) | 2,2 HDi | D |
| 2/18, 5, 7, 10, 11 | 406 Coupe (2000-2006) | 98 (133) | DW12ATED (4HZ) | 2,2 HDi | D |
| 2/18, 7, 10, 15, 17 | 407 (2005-2011) | 120 (163) | DW12BTED4 (4HP) | 2,2 HDi | D |
| 2/18, 7, 10 | 407 (2005-2011) | 120 (163) | DW12BTED4 (4HR) | 2,2 HDi | D |
| 2/18, 7, 10, 15, 17 | 407 (2006-2011) | 125 (170) | DW12BTED4 (4HT) | 2,2 HDi | D |
| 2/18, 7, 10, 15, 17 | 508 (2011-2013) | 150 (204) | DW12CTED4 (4HL) | 2,2 GT HDi | D |
| 2/18, 5, 7, 11 | 607 (2000-2007) | 98 (133) | DW12ATED (4HX) | 2,2 HDi | D |
| 2/18, 7, 10, 15, 17 | 607 (2006-2009) | 120 (163) | DW12BTED4 (4HP) | 2,2 HDi | D |
| 2/18, 7, 10, 15, 17 | 607 (2005-2009) | 125 (170) | DW12BTED4 (4HT) | 2,2 HDi | D |
| 2/18, 3/12, 4, 5, 7, 10, 11 | 807 (2002-2006) | 94 (130) | DW12ATED4/L4 (4HW) | 2,2 HDi | D |
| 2/18, 7, 10, 15, 16, 17 | 807 (2007-2010) | 120 (163) | DW12BTED4 (4HR) | 2,2 HDi | D |
| 2/18, 7, 10, 15, 16, 17 | 807 (2007-2010) | 125 (170) | DW12BTED4 (4HS) | 2,2 HDi | D |
| 2/18, 7, 10, 15, 16, 17 | 807 (2007-2010) | 125 (170) | DW12BTED4 (4HT) | 2,2 HDi | D |
| 3/12, 4, 5, 7, 10, 11 | Boxer II (2002-2006) | 77 (104) | DW12UTED (4HY) | 2,2 HDi | D |
| 3/12, 6, 8, 9, 10, 11 | 206 (1998-2004) | 51 (70) | DW8/L3 (WJZ) | 1,9 | D |
| 3/12, 6, 8, 9, 10, 11 | 206 (1999-2004) | 51 (70) | DW8B/L4 (WJY) | 1,9 | D |
| 3/12, 6, 8, 9, 10, 11 | 306 (1999-2002) | 51 (70) | DW8 (WJY) | 1,9 | D |
| 3/12, 6, 8, 9, 10, 11 | 306 (1998-2001) | 51 (70) | DW8/L/W3 (WJZ) | 1,9 | D |
| 3/12, 6, 8, 9, 10, 11 | 306 (1998-2001) | 51 (70) | DW8/L/W3 (WJZ) | 1,9 | D |
| 3/12, 6, 8, 9, 10, 11 | Expert I/II (1999-2007) | 51 (70) | DW8 (WJY) | 1,9 | D |
| 3/12, 6, 8, 9, 10, 11 | Expert I/II (1999-2007) | 51 (70) | DW8/L/W3 (WJZ) | 1,9 | D |
| 3/12, 6, 8, 9, 10, 11 | Partner/Partner Origin/Ranch I/II (1998-2002) | 51 (70) | DW8/L3 (WJZ) | 1,9 | D |
| 3/12, 6, 8, 9, 10, 11 | Partner/Partner Origin/Ranch I/II (1999-2007) | 51 (70) | DW8B (WJY) | 1,9 | D |